

RSV detection kit

CerTest

BIOTEC



Pathology and product description

Respiratory Syncytial Virus (RSV) is the most common cause of bronchiolitis and pneumonia among infants and children under 1 year of age. Illness begins most frequently with fever, runny nose, cough and sometimes wheezing. Severe lower respiratory tract disease may occur at any age, especially among the elderly or among those with compromised cardiac, pulmonary or immune systems.

RSV is spread from respiratory secretions through close contact with infected persons or contact with contaminated surfaces or objects.

CerTest RSV card test is based on the principle of a qualitative immunochromatographic assay for the determination of *Respiratory Syncytial Virus* from nasal swab, nasopharyngeal wash or aspirate specimens.



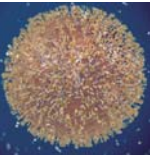

Test procedure A using nasal swab samples

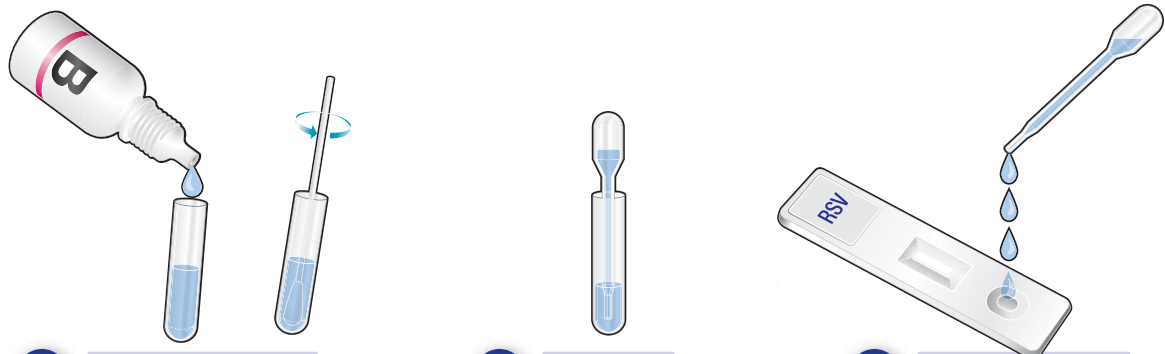

step 1 Add 15 drops of the Reagent B and put the swab into the tube. Mix the solution by rotating the swab forcefully 1 minute.

step 2 Extract the liquid with the pipette.

step 3 Dispense 4 drops from the testing tube into the circular window marked with the letter "S".

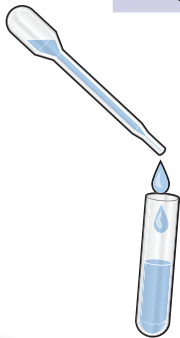

step 1 Add 6 drops of the nasopharyngeal wash or aspirate samples into the testing tube.



step 2 Add 9 drops of the Reagent B in the same testing tube. Homogenize 1 minute with the vortex.



step 3 Extract the liquid with the pipette.

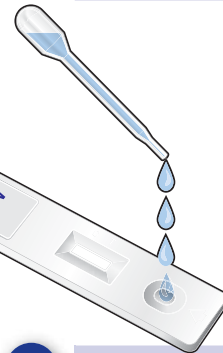

step 4 Dispense 4 drops from the testing tube into the circular window marked with the letter "S".

Test procedure B, using nasopharyngeal wash or aspirate samples

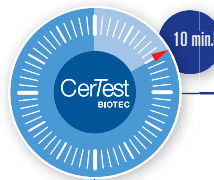

Wait for coloured bands to appear, Read the results at 10 minutes

Interpretation of the results



C RSV Negative
T



C RSV Positive
T



C Invalid
T



C Invalid
T

Clinical Sensitivity and Specificity

	Sensitivity	Specificity	PPV	NPV
CerTest RSV vs. BinaxNow® RSV	95%	>99%	>99%	91%



CERTEST BIOTEC, S.L.
Pol. Industrial Río Gállego II, Calle J, Nº 1,
50840, San Mateo de Gállego, Zaragoza (Spain)
www.certest.es

